



EXHIBITION QUARTER, BOWEN HILLS

WHAT: PROJECT COMMENCEMENT - COMMUNITY CONSTRUCTION INFORMATION
WHEN: February 2023
WHERE: BRISBANE SHOWGROUNDS PRECINCT

To our valued community,

An exciting new development is coming to the Brisbane Showgrounds precinct.

Exhibition Quarter is a new build-to-rent development offering 443 residences in a mix of studio, one-, two- and three-bedroom apartments over 37 levels.

Lendlease and QuadReal have appointed Hutchinson Builders to deliver the project that will be fully electric and target a 5 Star Green Star Buildings Version 1 rating.

Residents will have access to premium amenities and communal spaces which will include a 25m lap pool with beach edge, podcast / music recording studios, BBQ pavilion, fully equipped gym, co-working facilities, outdoor spa retreat, dog wash facilities, yoga room, resident lounges and much more.

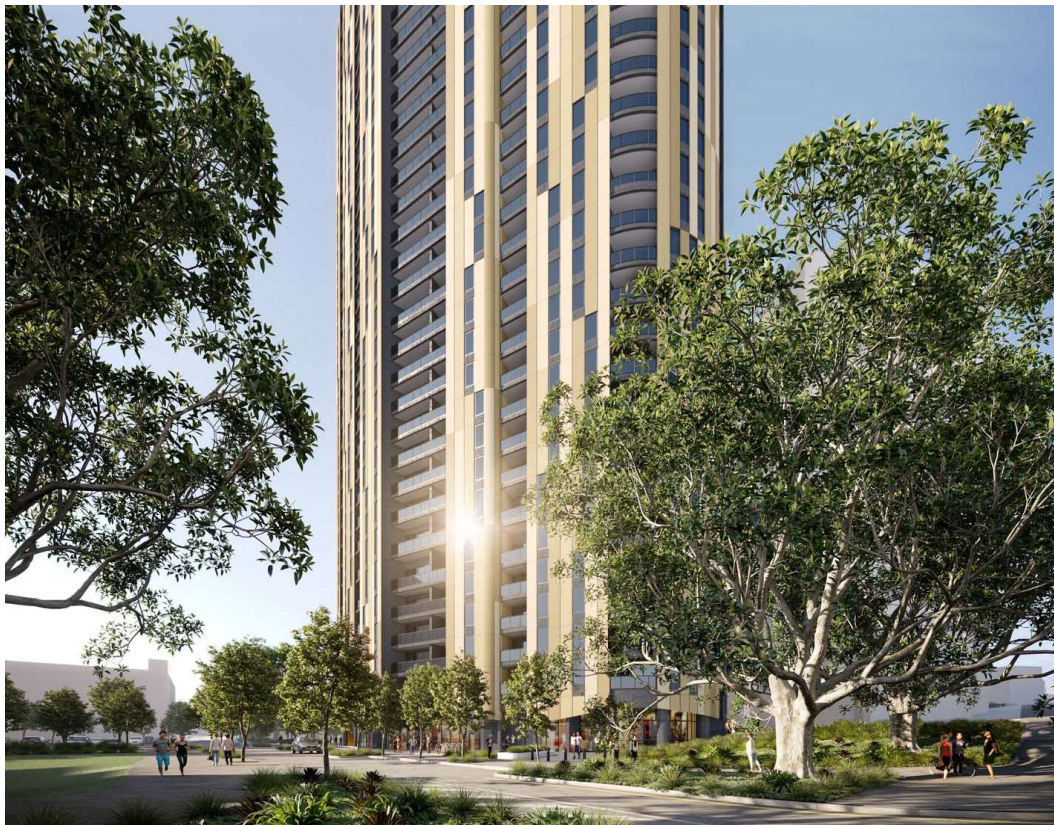



What to expect?

Early works will commence on Monday 6 February 2023, involving site establishment and demolition works. Operating hours are typically 6.30am to 6.30pm Monday to Saturday. Deliveries to site will be via Alexandria St. only.

For any road closures that may be required during construction, Hutchinson Builders will ensure all stakeholders are well informed of any potential impacts via a website update.

Residents, workers, or business owners directly impacted will be informed via a letterbox drop.

Throughout construction, we'll keep you informed of planned works and progress on site via this construction update.

In the meantime, we'll continue to do everything possible to minimise any inconvenience – and thank you for your patience while we deliver this exciting new project to Brisbane Showgrounds.

If you have any further questions about the development or the broader precinct, please do not hesitate to contact Shannon Volp, Stakeholder and Community Engagement Manager, Lendlease Development.

For any site specific or operational questions, please contact to Mario Crismani, Construction Manager, Hutchinson Builders.

Yours sincerely,

Shannon Volp
Stakeholder and Community Engagement Manager
Lendlease Development
0438 468 536

Shannon.volp@lendlease.com



Mario Crismani
Construction Manager
Hutchinson Builders
0431 642 335

mario.crismani@hutchies.com.au

